

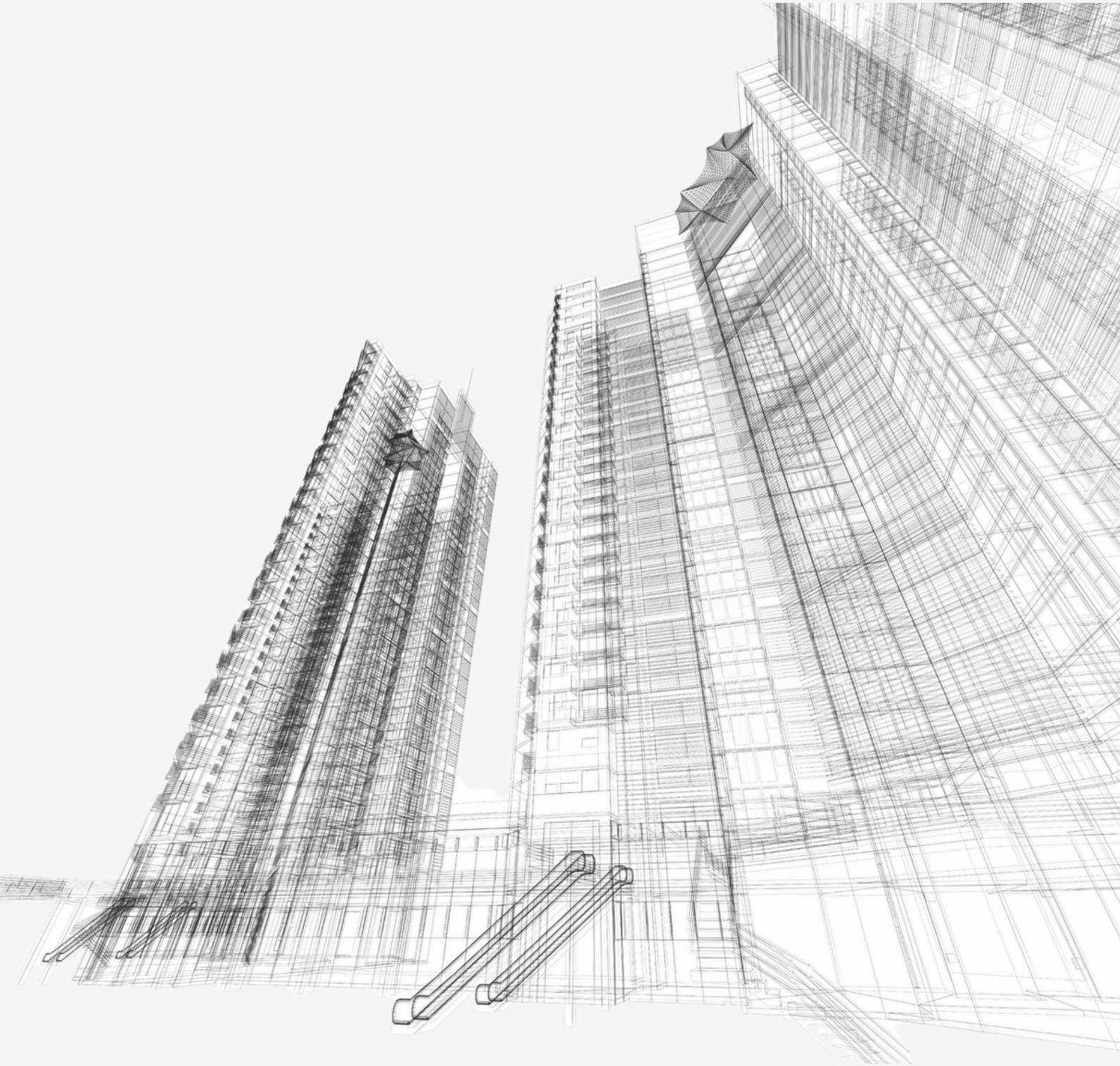

BUILDING PERFORMANCE ANALYTICS

ENVIRONMENTAL CLEARANCE



REINVENT DESIGN TECHNOLOGIES LLP

[www.rdt-corp.com](http://www.rdt-corp.com)

# ENVIRONMENTAL CLEARANCE EIA SIMULATIONS

## 1. Shadow Analysis

- The aim of the study is to assess the potential impact of the development with respect to sunlight and shadow analysis.

## 2. Daylight Analysis

- The aim of the study is to evaluate the indoor daylight comfort using IESVE

## 3. Wind (CFD) Analysis

- The analysis evaluates potential effects on comfort, wind loads, and ventilation, identifying risks that might arise from altered airflow.

## 4. Urban Heat Island Analysis

- To understand Outdoor Thermal Comfort with UTCI.

## 5. ECBC Simulation Report

- To evaluate the building's compliance with ECBC by assessing envelope performance, HVAC systems, lighting, and energy consumption through simulation-based analysis, and to identify opportunities for energy efficiency improvement.

## 6. HPBD (High Performance Building Design) Report

- To evaluate the building's performance through integrated analysis of shadow, wind, daylight, natural ventilation, and urban heat island effects, in order to optimize design decisions, enhance occupant comfort, and minimize environmental impact

## 7. Traffic Impact Assessment & Evacuation Analysis

- The aim of the study is to analyze the traffic movement on the access roads leading to the site, as well as the movement of vehicles within the site itself.

## 8. Carbon Footprint Analysis

- To assess the project's carbon footprint and evaluate opportunities for emission reduction.

## 9. Product LCA

## 10. Load Estimation

## 11. Basement ventilation

## 12. Land Use and Land Cover Report

## 13. Trees & Landscape Report

## 14. Dewatering & Basement Air Cleaning

DETAIL REPORT  
PREPARATION OF  
ADDITIONAL STUDIES  
FOR SEAC MEETING

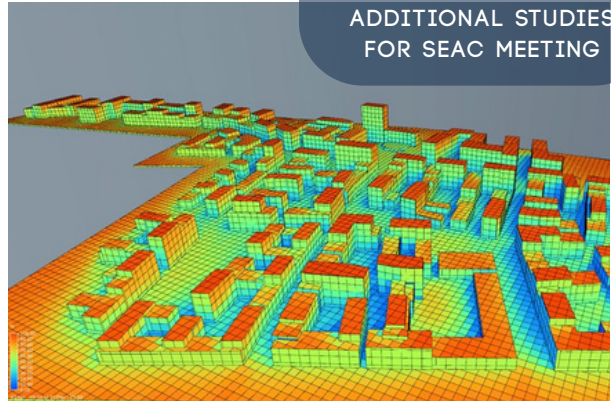

SUMMARY REPORT  
FOR SEAC  
PRESENTATION

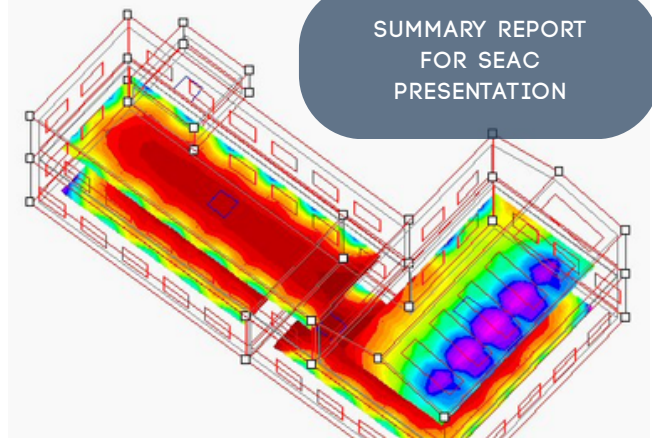

SEAC MEETING  
SUPPORT

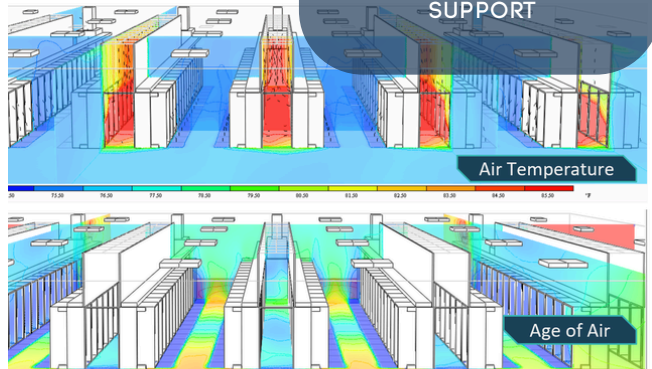

FILLING PARVESH  
FORM FOR EC  
REGISTRATION

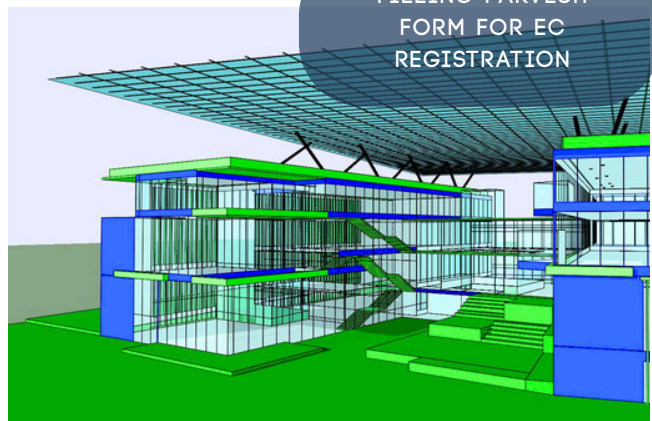

## OUR ACHIEVEMENTS

490+ Completed Projects

### B1 CATEGORY PROJECTS

150+ Completed Projects

### B2 CATEGORY PROJECTS

384+ Mumbai region projects

### SEAC 2

256+ Pune and ROM region projects

### SEAC 3

20+ Valued Clients

### MARKET DOMINANCE



640+ projects in Mumbai, Pune & Maharashtra

100+ projects ROM

## PROJECTS IN INDIA



**Aniket Chaudhari**  
Founder & Managing Partner



**Aniket Galande**  
Designated Partner



**Gauri Kulthe**  
Project Manager



**Akanksha Oak**  
Sr. Project Consultant



**Simran Pathan**  
Sr. Project Consultant



**Sakshi Ahire**  
Project Consultant



**Tushar Shingane**  
Project consultant



**Jay Amge**  
Jr. Project consultant



**Aditya Rajguru**  
Jr. Project consultant



**Somnath Dhattrak**  
Jr. Project consultant



**Mahesh Hiray**  
Jr. Project consultant



**Rutik Shinde**  
Jr. Project consultant



**Aditya Chandore**  
Jr. Project consultant



**Rushikesh Umbarkar**  
Jr. Project consultant

TEAM  
**rdt** 15+

## OUR PROJECTS



Project name: Port 133  
Location of project: Pune  
Services provided: ECBC analysis, HPBD Analysis, Carbon footprint analysis  
Type of the project: Hospitality & Commercial  
Category of the project: B1  
Presented to: SEAC III



Project name: PHRCLS Health City  
Location of project: Pune  
Services provided: Traffic analysis report, ECBC analysis, Shadow Analysis, Wind analysis, Daylight Analysis, UHIE Analysis  
Type of the project: Healthcare  
Category of the project: B1  
Presented to: SEAC III



Project name: M/s. Persipina Developers Pvt. Ltd.  
Location of project: Panvel, Mumbai  
Services provided: Shadow Analysis, Wind analysis, Daylight Analysis, Swept path Analysis, UHIE Analysis  
Type of the project: Residential  
Category of the project: B1  
Presented to: SEAC II



Project name: Redevelopment Scheme by MMRDA (Mata Ramabai Ambedkar Nagar)  
Location of project: Ghatkoper, Mumbai  
Services provided: Traffic analysis report, ECBC analysis, HPBD Analysis, Carbon footprint analysis  
Type of the project: Mixed use development  
Category of the project: B1  
Presented to: SEAC II



Project name: Avante Spaces  
Location of project: Pune  
Services provided: ECBC analysis, Shadow Analysis, Wind analysis, Daylight Analysis, UHIE Analysis  
Type of the project: Commercial  
Category of the project: B1  
Presented to: SEAC III

## OUR PROJECTS



**Project name:** Marathon Nexzone (MMRDA)  
**Location of project:** Panvel, Raigad  
**Services provided:** ECBC analysis, HPBD Analysis, Carbon footprint analysis, Traffic Analysis, BACS Analysis  
**Type of the project:** Residential & Commercial  
**Category of the project:** B1  
**Presented to:** SEAC II

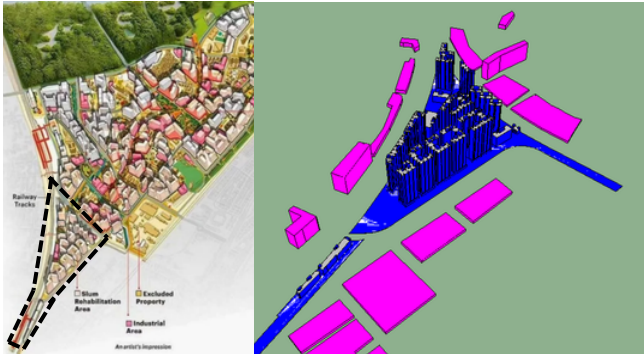

**Project name:** Plot C, Dharavi Redelopment project (Navbharat Mega Developers)  
**Location of project:** Dharavi, Mumbai  
**Services provided:** ECBC analysis, HPBD Analysis, Carbon footprint analysis, Traffic Analysis, BACS Analysis  
**Type of the project:** Mixed use Development (Township)  
**Category of the project:** B1  
**Presented to:** SEAC II



**Project name:** AURIC-Perkins India Pvt Ltd  
**Location of project:** Ch. Sambhaji Nagar  
**Services provided:** ECBC analysis, Carbon footprint analysis, Traffic Analysis  
**Type of the project:** Industrial  
**Category of the project:** B1  
**Presented to:** SEAC III



**Project name:** M/s Kirloskar oil Engines Ltd.  
**Location of project:** Kolhapur  
**Services provided:** ECBC analysis, Carbon footprint analysis, Traffic Analysis  
**Type of the project:** Industrial  
**Category of the project:** B1  
**Presented to:** SEAC III



**Project name:** Finolex Cables Ltd.  
**Location of project:** Urse, Pune  
**Services provided:** ECBC analysis, Shadow Analysis, Carbon footprint analysis, Traffic Analysis  
**Type of the project:** Industrial  
**Category of the project:** B1  
**Presented to:** SEAC III

## OUR PROJECTS



Project name: Fortis S L Raheja Hospital  
Location of project: Mahim west, Mumbai  
Services provided: Shadow Analysis, Wind analysis, Daylight Analysis, UHIE Analysis  
Type of the project: Healthcare  
Category of the project: B2  
Presented to: SEAC II



Project name: Dr. D.Y. Patil Pratishthan  
Location of project: Akurdi, Pune  
Services provided: ECBC analysis, Shadow Analysis, Carbon footprint analysis, Traffic Analysis  
Type of the project: Institutional  
Category of the project: B1  
Presented to: SEAC III



Project name: Sea Rock Bandra (ELEL Hotels & Investment Ltd.)  
Location of project: Mumbai  
Services provided: ECBC analysis, Shadow Analysis, Wind analysis, Daylight Analysis, UHIE Analysis  
Type of the project: Hospitality  
Category of the project: B2  
Presented to: SEAC II



Project name: Data Center Holdings India LLP.  
Location of project: Navi Mumbai  
Services provided: ECBC analysis, HPBD Analysis, Carbon footprint analysis, Traffic analysis  
Type of the project: Datacentre  
Category of the project: B1  
Presented to: SEAC II



Project name: M/s. Ctrl S Datacenter Limited.  
Location of project: Navi Mumbai  
Services provided: ECBC analysis, HPBD Analysis, Carbon footprint analysis, Traffic analysis  
Type of the project: Datacentre  
Category of the project: B1  
Presented to: SEAC II

## OUR PROJECTS



Project name: Lodha group Bund Garden  
Location of project: Pune  
Services provided: Daylight analysis, Wind Analysis, UHIE Analysis  
Type of the project: Residential  
Category of the project: B2  
Presented to: SEAC III



Project name: The Resort (Pleasant palace)  
Location of project: Mumbai  
Services provided: Daylight analysis, Wind Analysis, UHIE Analysis, Shadow Analysis  
Type of the project: Hotel  
Category of the project: B2  
Presented to: SEAC II



Project name: Ms Mahindra & Mahindra Ltd.  
Location of project: Igatpuri, Nashik  
Services provided: ECBC analysis, HPBD Analysis, Carbon footprint analysis, Traffic Analysis  
Type of the project: Industrial  
Category of the project: B2  
Presented to: SEAC III



Project name: The Resort  
Location of project: Malad west, Mumbai  
Services provided: Daylight analysis, Wind Analysis, UHIE Analysis, Shadow Analysis  
Type of the project: Hotel & Commercial  
Category of the project: B2  
Presented to: SEAC II



Project name: Raymond Commercial  
Location of project: Thane  
Services provided: Daylight analysis, Wind Analysis, UHIE Analysis, Shadow Analysis  
Type of the project: Residential & Commercial  
Category of the project: B2  
Presented to: SEAC II

# ANALYSIS CAPABILITIES

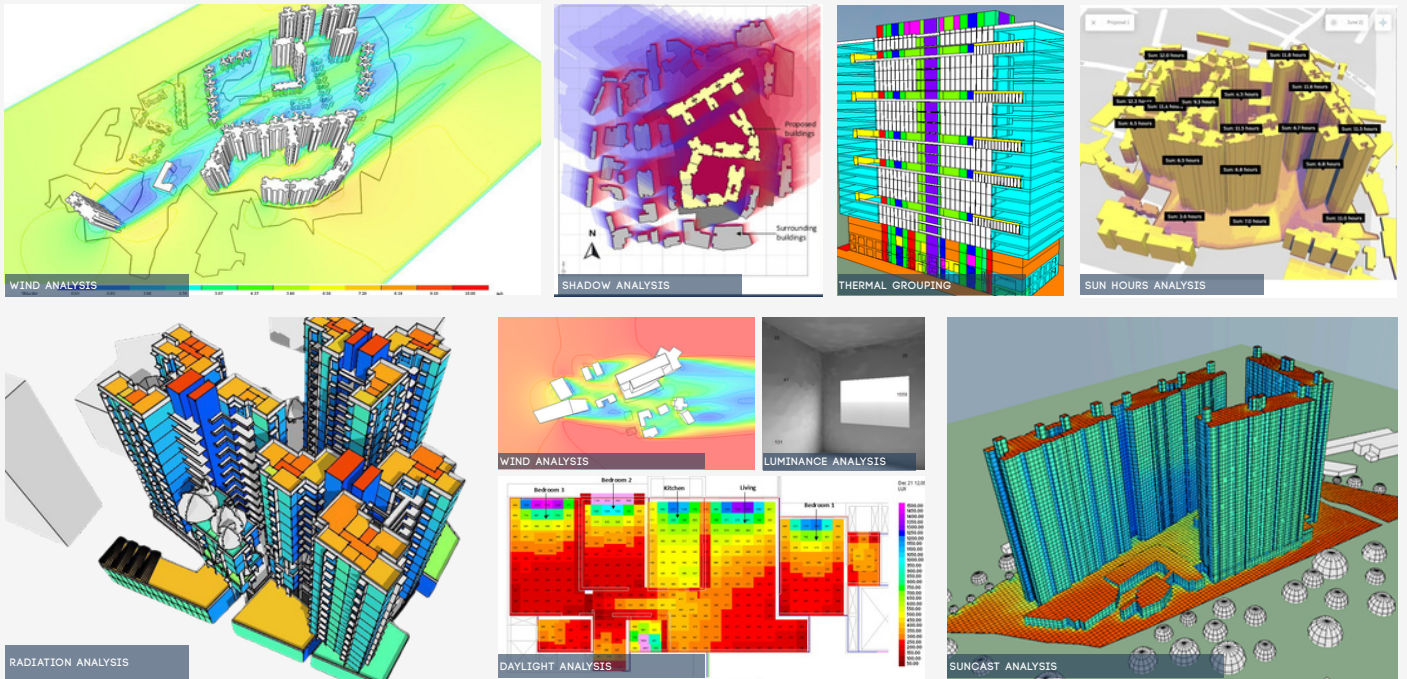

# OUR CLIENTS



CONNECT WITH US!

- 
- [www.rdt-corp.com](http://www.rdt-corp.com)
- [contact@rdt-corp.com](mailto:contact@rdt-corp.com)
- +91 9820941094, +91 9028697110
- 304, 3rd floor, Swapnali CHS, Near Cafe PNQ, Kothrud Pune 411039, Maharashtra India.
- Office no. 10, Shyama Homes, Besides Ashoka Medicover Hospital, Indira nagar, Nashik 422009